



# Data Sheet

## Coaxial Relay CX-140D 24 V

### MECHANICAL CHARACTERISTICS :

Contact Arrangement	.....	SPDT
RF Contacts	.....	Break before make
Operational Temperature	.....	- 25°C to + 50°C
Max Temperature Rise	.....	20°C
Weight	.....	Approx. 95 g
Mounting	.....	Four screws
Cable Connections	.....	N-Female, directly connect cables

### ELECTRICAL CHARACTERISTICS :

Impedance	.....	50 Ohms
Nominal Voltage	.....	24 V DC
Voltage Range	.....	20 V DC - 26 V DC
Current	.....	40 mA @24 V DC 20°C
Coil Resistance	.....	600 ±10% Ohms @ 20°C

### RF-PROPERTIES :

Frequency MHz	VSWR max	Isolation -dB(min)	Ins. Loss -dB(max)	RF Power input W
50	1.03	55	0.08	250
150	1.03	51	0.10	250
500	1.05	47	0.15	200
1000	1,06	34	0.20	150
1500	1.20	28	0.25	100

### ACTUATION DATA :

Pull In	.....	20 V DC - 26 V DC (24 V DC nominal)
Drop Out	.....	6,9 V DC min.

### SWITCHING TIME :

Pull In	.....	15 ms typical
Drop Out	.....	10 ms typical
Life Expectancy	.....	500.000 Operations min.

# Coaxial Relay CX-140D 24 V

## DIMENSIONS :

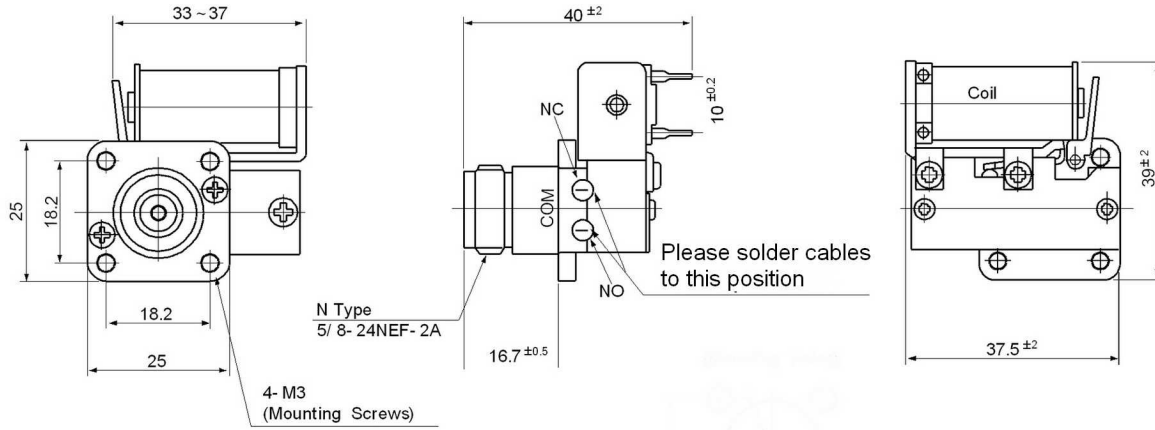

## Typical Operating Curves :

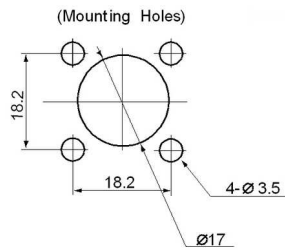
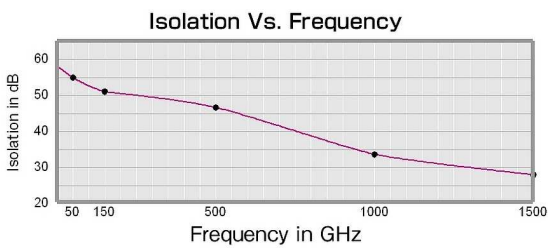
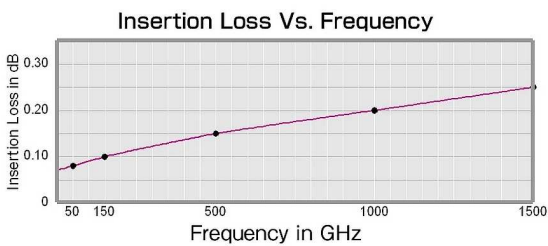
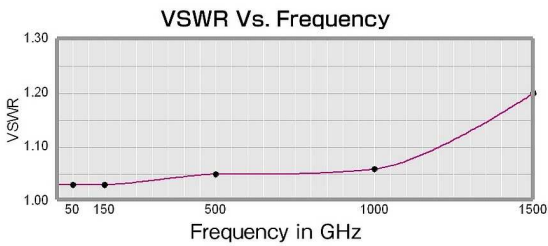

### Cable Termination

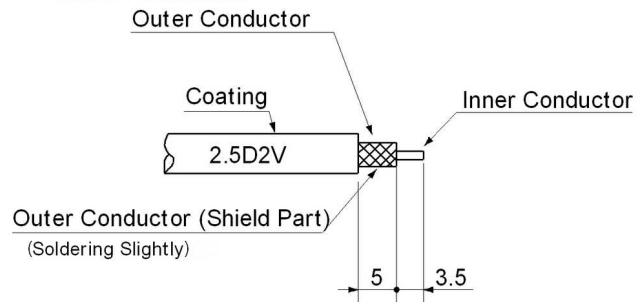

## Schematic:

