

REV	DESCRIPTION	DRAWN	DATE

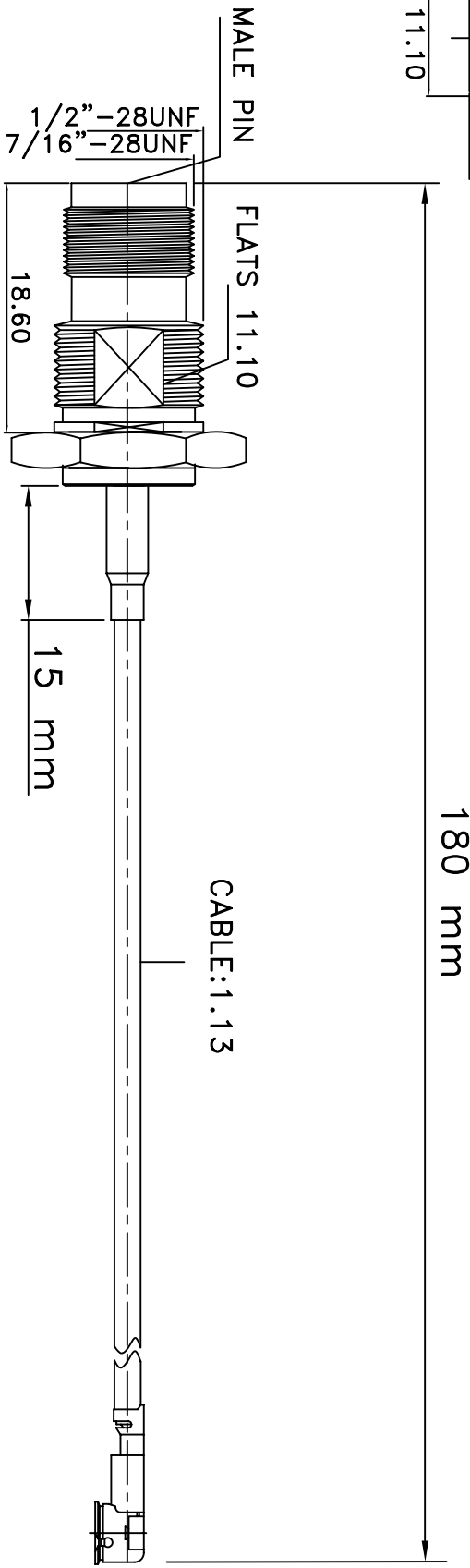

TNC FEMALE RP BULKHEAD

MHF IPEX

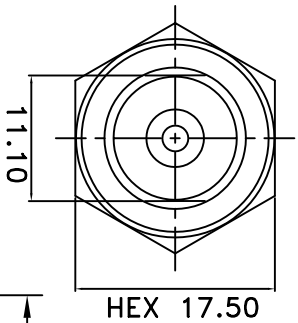
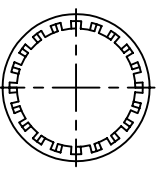
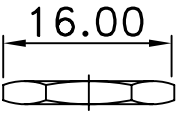

NO	Description	Qty	Material	Finish
3	MHF IPEX	1	BRASS	GOLD
2	CABLE: 1.13	1		
1	TNC-18-38-RP-I-TGN	1	BRASS	NICKEL

UNLESS OTHERWISE SPECIFIED
 1. REMOVE ALL BURRS.
 2. BREAK ALL CORNERS & EDGES CO.15 MAX.
 3. CHAMFER 1ST & LAST THREADS 45°.
 4. DIAMETERS ON COMMON CENTERS.
 5. ALL DIMENSIONS ARE AFTER PLATING.

* MAJOR DIMENSION
 UNLESS OTHERWISE NOTED
 0.5-6 = ±0.2
 6-30 = ±0.4
 30-120 = ±0.6
 120-315 = ±1.0
 ANGLES = ±1°

SCALE	5/1	UNIT	MM	DRAWN DATE

APPROVED	TITLE	FILE NO.
CHECKED	TNC FEMALE RP BKD+1.13+IPEX	1838113IPEX-180
DRAWN	DRAWING NO.	REV
andrew	1838113IPEX-180	A

